

# Mighty Quick Start Guide



**fetch**

# What’s inside

Step 1. Unpack the box .....	4
Activation Code .....	5
Important Tips .....	5
Step 2. Connect to your Broadband Modem .....	6
Step 3. Connect to your TV Antenna .....	8
Step 4. Connect to your TV .....	9
Step 5. Power up your Fetch Mighty .....	10
Step 6. Start up your Fetch Mighty .....	11
Fetch Mobile App .....	12
Remote Control .....	13
Fetch Mighty .....	15
Troubleshooting .....	17
Specifications .....	19
Compliance .....	23
Contact .....	23
Keep in touch .....	24
User Guides .....	24

# All your entertainment, easy

Welcome to Fetch! Fetch combines Free TV, Catch-Up, premium channels, streaming apps, and movies all in one place; with Universal Voice Search so it's easy to find and start watching.

There are 6 easy steps to get you started:

- 1 Unpack the box
- 2 Connect the Fetch box to your broadband modem
- 3 Connect the Fetch box to your TV Antenna
- 4 Connect the Fetch box to your TV
- 5 Power up your Fetch Mighty
- 6 Start up your Fetch Mighty

This guide tells you all you need to know about setting up and turning on your Fetch Mighty. It also has important safety and usage information.

# Step 1. Unpack the box

Before you install your Fetch Mighty, check that all the accessories you need have been supplied using this page as a checklist.

## What's in the box:



Fetch Mighty

Remote Control with batteries

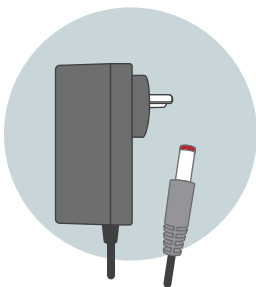

Power Supply



HDMI Cable

The included remote varies depending on where you got your Fetch Mighty. Information on Fetch remotes is available at [fetch.com.au/remote](https://fetch.com.au/remote). The Voice Remote is available for purchase at [fetch.com.au/voice](https://fetch.com.au/voice).

# Activation Code

If you got Fetch from your broadband or phone provider, they will have sent you an email and/or SMS with your Activation Code. Please contact them if you can't find your Code.

If you got your Fetch box from a retailer or directly from Fetch, go to [fetch.com.au/activate](https://fetch.com.au/activate) to get your Activation Code. If you already have another Fetch box and account, go to [fetch.com.au/account](https://fetch.com.au/account) to add this Mighty to your existing account.

## Important Tips

- Place the Fetch box on a level surface.
- Don't stack it on anything that vibrates or generates heat.
- Make sure there's 5cm of space around the Fetch box for airflow.
- The remote control works up to 6m away from the Fetch box in Infrared mode.  
The voice remote control works up to 10m away in Bluetooth mode.\*
- Unplug the Fetch box from the power source before cleaning.
- Clean using a dry cloth only – don't use water or chemicals.
- Don't try to open the Fetch box – it's dangerous and will void your warranty.
- Use only with a 100V-240V 50Hz AC power source.
- Use only the power supply provided.
- Keep liquid, children and pets away from the Fetch box at all times.
- For any problems with your Fetch box, if you have an account directly with Fetch go to [fetch.com.au/account](https://fetch.com.au/account). If you got Fetch from your broadband or phone provider, please contact them for assistance.

\*The included remote varies depending on where you got your Fetch box. See [fetch.com.au/remotes](https://fetch.com.au/remotes) for more information on Fetch remotes.

# Step 2. Connect to your Broadband Modem

Fetch is delivered by broadband Internet, so you need to connect your Fetch Mighty to the modem.

There are various ways to do this:

## Option 1: Wi-Fi Connection

**Connect your Modem to your Fetch Mighty via Wi-Fi**

Use this option if:

- Your modem is not close to your TV, and
- You have reliable Wi-Fi in the room where your TV is.

If you're using this connection option you can go straight to Step 3. Connect to your TV Antenna on Page 8 now.

You will set your Wi-Fi up later when you get to Step 6. Start up your Fetch Mighty.

## Option 2: Wired Connection

**Connect your Modem to your Fetch Mighty via Ethernet cable**

This is the most reliable connection option. Use this option if:

- You can run an Ethernet cable directly from your Modem to your Fetch Mighty.

3rd Generation Mighty (M616T)

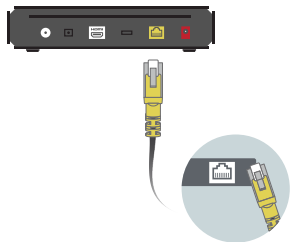

4th Generation Mighty (M681T)

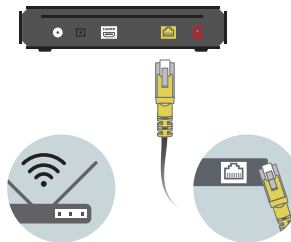

To connect, follow these steps:

- 1 Plug one end of an Ethernet cable into a free port on your broadband modem.
- 2 Plug the other end into the port labelled INTERNET on the back of your Fetch Mighty.

### Option 3: Data cabling

#### Connect your Modem to your Fetch Mighty using data cabling

Use this option if:

- Your modem is not close to your TV, and
- Your installation location has cabling with an Ethernet port nearby.

3rd Generation Mighty (M616T)

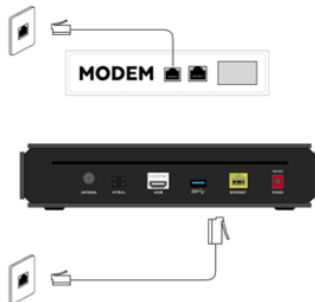

4th Generation Mighty (M681T)

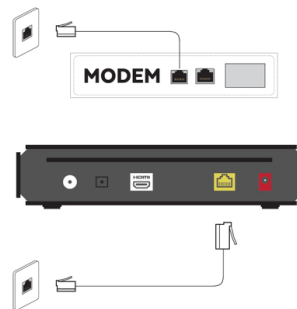

To connect, follow these steps:

- 1 Plug one end of an Internet Ethernet cable into a free port on your broadband modem.
- 2 Plug the other end into the Internet Ethernet wall socket nearest to your broadband modem.
- 3 Plug one end of a second Internet Ethernet cable into the port labelled INTERNET on the back of your Fetch Mighty.
- 4 Plug the other end into the Internet Ethernet wall socket nearest your TV and Fetch Mighty.

# Step 3. Connect to your TV Antenna

You get your Free-to-Air Digital TV channels using your normal TV antenna. They are not delivered over broadband Internet. You'll need your existing TV antenna cable, so unplug it from the back of your TV.

3rd Generation Mighty (M616T)

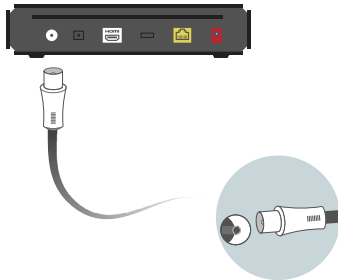

4th Generation Mighty (M681T)

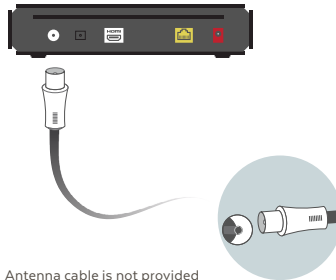

- 1 Plug one end of the existing antenna cable into the antenna wall socket, or leave if already connected to the wall.
- 2 Plug the other end of the antenna cable into the socket labelled Antenna on the back of your Fetch Mighty.



# Step 4. Connect to your TV

The Fetch Mighty connects to your TV using HDMI (High Definition Multimedia Interface). Only the HDMI cable is needed.

3rd Generation Mighty (M616T)

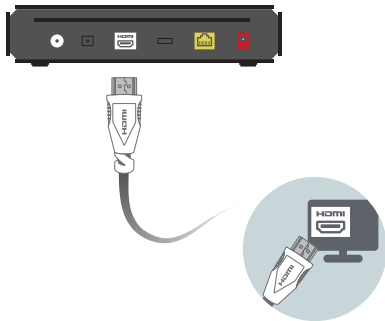

4th Generation Mighty (M681T)

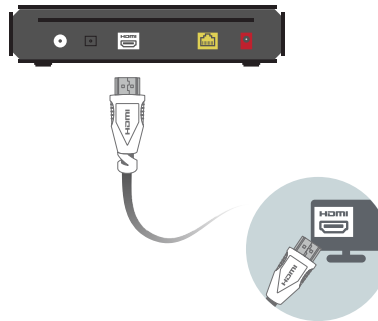

- 1 Plug the HDMI cable into the port labelled HDMI on the back of the Fetch Mighty.
- 2 Plug the other end into a free HDMI port on your TV.

**To watch content in 4K on your Fetch Mighty, you'll need:**

- A connected 4K HDR TV
- A steady home broadband speed of 15-25 Mbps
- Video setting set to Auto (4K - 2160P) on your Fetch Mighty (you can do this later on Fetch at [Menu > Manage > Settings > Audio & Visual > Video](#))

Your TV and home theatre equipment such as audio video receiver or sound bar if using, also need HDMI inputs that support 4K and HDMI 2.0/HDCP 2.2 signals. Check your TV manual for more info.

To watch High Dynamic Range (HDR), you'll need to enable the option on your TV if supported and then later on your Fetch Mighty at [Menu > Audio & Visual > Advanced > HDR Mode](#). Different TVs may use other names like "Ultra" or "Deep Colour".

# Step 5. Power up your Fetch Mighty

Once you've completed all the steps and put the batteries in your remote control it's time to turn everything on.

## Connect your Fetch Mighty to power

- 1 Plug the red end of the power supply unit into the Fetch Mighty.
- 2 Plug the power supply unit into the wall power socket.

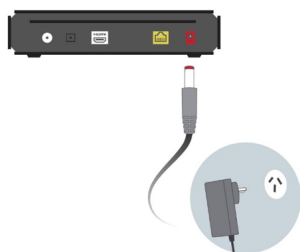

## Select Source / Input on TV







- 1 Turn on your TV.
- 2 On your TV remote press Source/Input or AV Select.
- 3 Select the HDMI port you plugged your Fetch Mighty into.

## Turn on your Fetch Mighty

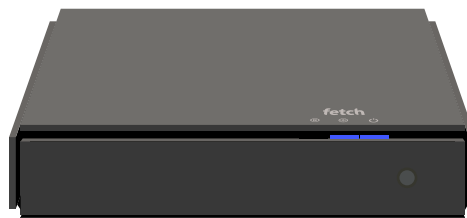
Turn on the Power at the wall socket. The power light  on your Fetch Mighty will light up.

## Check the Fetch Mighty Connection



-  Standby light is blue when your Fetch Mighty is powered on. If it is red, the box is in standby mode and you should press the power button on the remote control to turn it on.
-  Internet light on your Fetch Mighty is blue when you have a broadband connection. If it is red, there is no live connection. During initial start-up it will change from red to blue.
-  Recording light on your Fetch Mighty will flash when you press any button on the remote. If it doesn't flash the box is not responding to the remote.

### Note

The back panel of your box may look different to the diagram but the functionality remains the same (see Page 16).

# Step 6. Start up your Fetch Mighty

This is the home stretch where you activate your Fetch service and get it all happening. It will take a few minutes for your Fetch Mighty to move through three loading screens and the screen may go black between each one. Don't worry, this is normal. Once finished simply follow the instructions on the Welcome Screen.

## Pair your Fetch Voice Remote

If using a Fetch Voice Remote (Page 13) your Fetch Mighty will prompt you to pair the remote during the start-up process. You can also do this later at [Menu > Manage > Settings > Remote Control](#).

## Connect to your home Wi-Fi network

Your Fetch Mighty will check your connection to the Internet and prompt you if you need to connect. If you are already connected there is no need to set up Wi-Fi. If you are connecting using Wi-Fi:

- 1 Choose 'Wi-Fi Connection' and follow the prompts.
- 2 Select your home network from the list of in range networks. If needed, confirm the security settings.
- 3 Your Fetch Mighty will let you know once you're connected then continue to start up.

## Welcome Screen

- Use your remote to enter the Activation Code for your Fetch box. For more information see Activation Code on Page 5. Your code (which is case-sensitive) will then be checked and confirmed.
- If the feature is available to you, you can choose another Name for your Fetch Mighty.
- The box will next try set up the remote to control your TV. Do this now or later at [Menu > Manage > Settings > Remote Control](#).
- Choose 5.1 Surround Sound for Fetch, if your sound system supports this Audio Setting.
- Next you can set up your Parental PIN. Do this now or later at [Menu > Manage > Settings > User > PIN Change](#). If you've already set your PIN then you'll just need to confirm it.
- Your PIN is used for many things on Fetch such as renting movies, buying TV shows, adding channel packs, and watching restricted content. It's a good idea to write it down in case you forget it but make sure you always keep it secure. (You may want to keep it a secret from your children too).
- The box will then do a Channel Scan which may take up to 5 minutes. The box will check Diagnostics then show the location of the Fetch TV Privacy Policy. Select Finish to restart and load the Fetch main menu.

Do not turn off or reboot your Fetch Mighty at any time during set up. Software updates can take up to 5 minutes.

Visit [fetch.com.au/guides](https://fetch.com.au/guides) to download the Fetch Mighty User Guide and get the most from your service.

# Fetch Mobile App

Control your Fetch Mighty with your tablet or mobile phone at home or when you're out and about, using the Fetch Mobile app.

- Download to go.
- Set recordings from anywhere.
- Handy second remote control.
- Watch channels, movies and TV Store shows.

To start go to the App Store or Google Play and install the Fetch app on your phone or tablet.



## Pair the app with your Fetch Mighty

Once you've installed the app on your phone or tablet you need to pair it with your Fetch Mighty.

For more information, go to [Menu > Manage > Settings > Mobile & Tablet](#) on your Fetch Mighty or visit [fetch.com.au/guides](https://fetch.com.au/guides) and download the Mobile App Guide.

# Remote Control

The remote control brings Fetch to life every time you use it. It has all the functions you need for quick and easy viewing. To make your remote control work, remove the battery cover, insert the two batteries supplied, and replace the cover.

## Set Up Universal Remote

You can use the Fetch remote to operate your TV as well as your Fetch Mighty. Your Fetch Mighty will try to set up your remote for you when you first set up your box but if that didn't work, you can set it up by going to [Menu > Manage > Settings > Remote Control](#).

For more information go to [fetch.com.au/guides](https://fetch.com.au/guides) and download the Universal Remote Instructions.

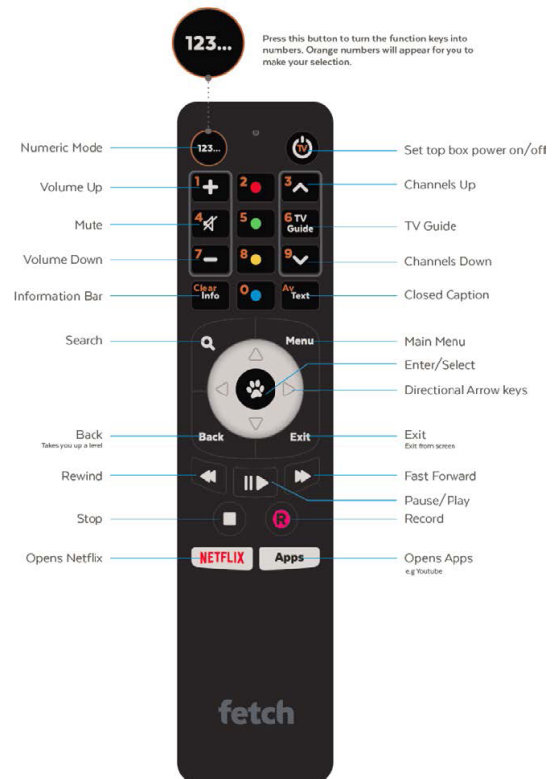

## Note

The included remote varies depending on where you got your Fetch Mighty. The Voice Remote is available for purchase at [fetchtv.com.au/voice](https://fetchtv.com.au/voice).

Your Fetch Mighty will pair your remote for you using Bluetooth when you first set up your box or you can do it later at [Menu > Manage > Settings > Remote Control](#).

For voice control, hold down  and speak into the microphone at the top of the remote.

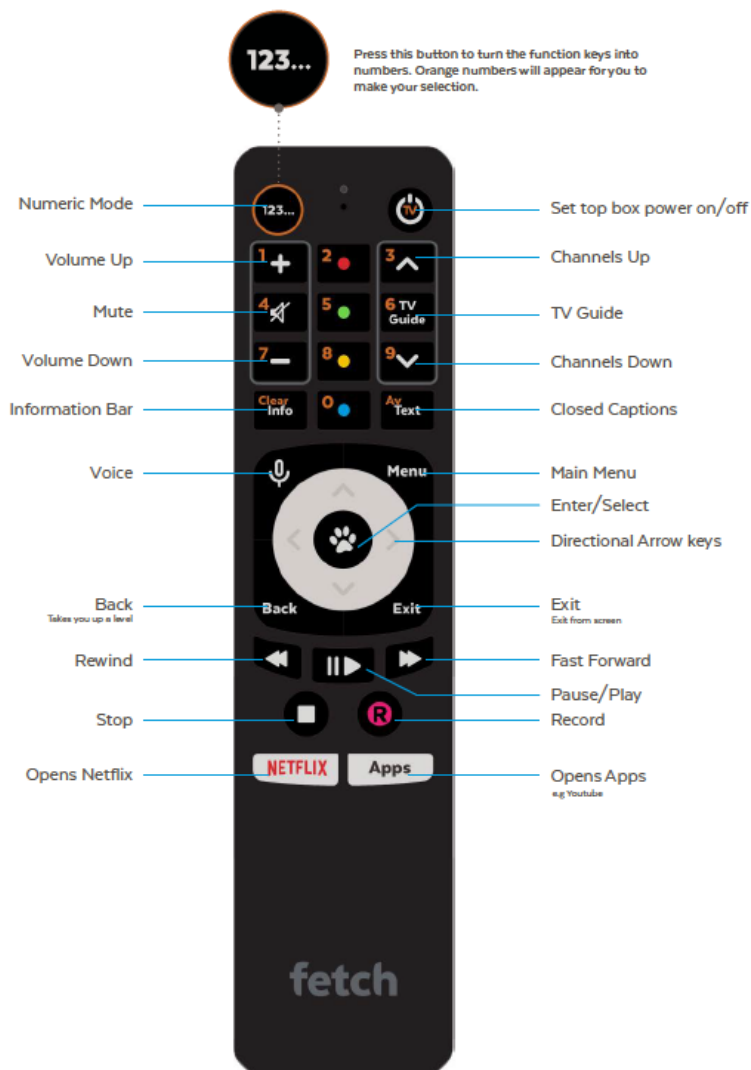

If your remote looks different to the images above, more information on Fetch remotes is available at [fetch.com.au/remotes](https://fetch.com.au/remotes).

# Fetch Mighty

## Front Panel

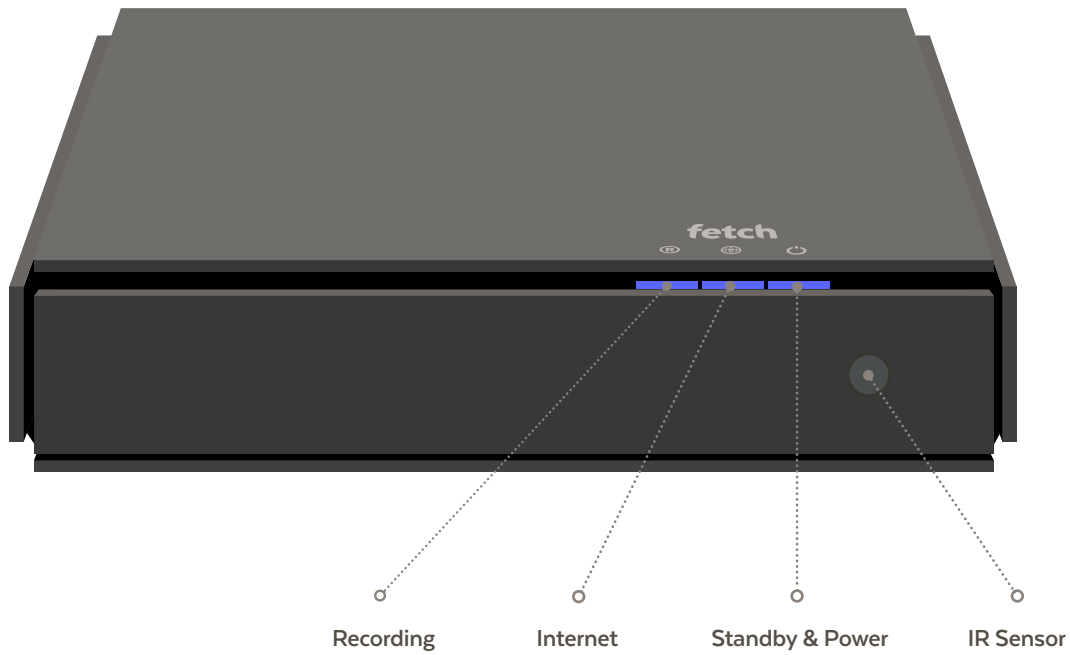

Back Panel

3rd Generation Mighty (M616T)

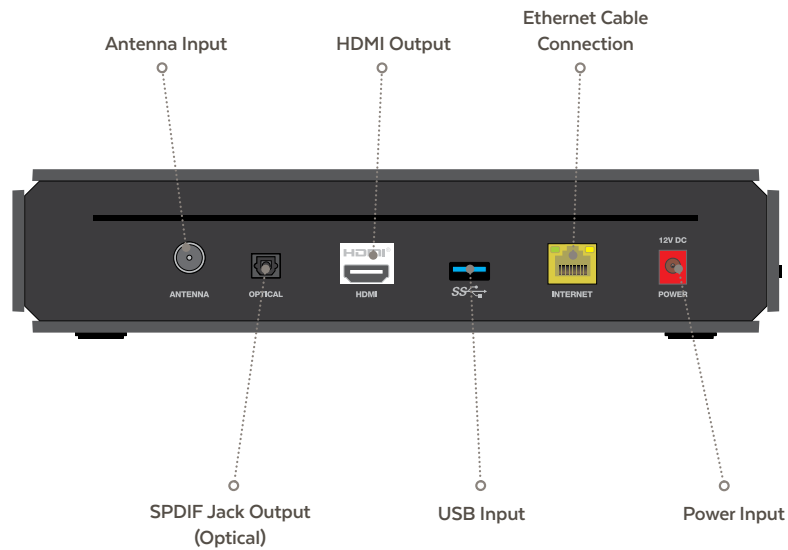

4th Generation Mighty (M681T)

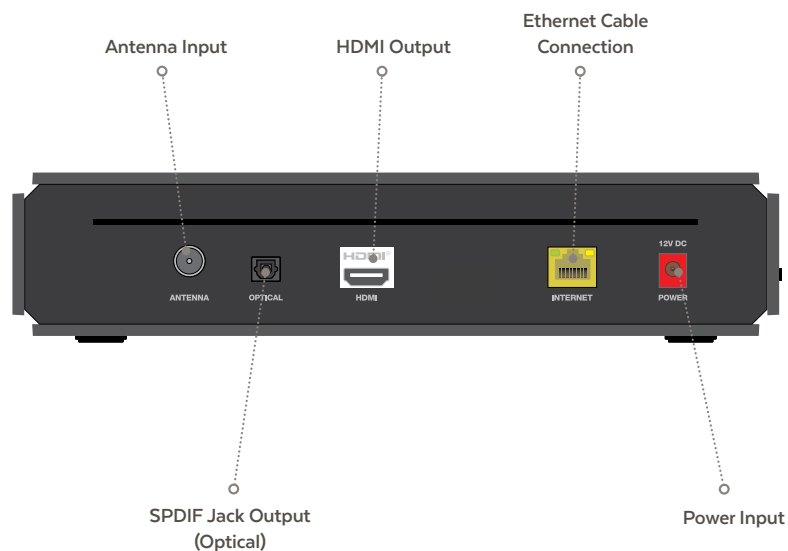



# Troubleshooting

If you're having trouble getting your Fetch Mighty to work check some of the tips below before you contact your Service Provider for help.



## Audio Visual Settings

- If your TV image appears out of proportion or stretched you may need to change the Display Resolution, Aspect Ratio and Display Mode. Go to [Main Menu > Manage > Settings > Audio & Visual > Visual](#).
- If you have issues watching 4K or HDR, make sure your cabling and TV are 4K-capable (Page 9). You may need to change the Display Resolution in [Audio & Visual > Video](#) or HDR Mode at [Audio & Visual > Advanced](#).

## Cabling and TV

- Make sure the power supply unit is correctly connected (Page 10), and there is power available at the wall power point.
- Check that the AV connections are secure and, if needed, try another connection mode (Page 9).
- Make sure the TV is set to the right AV input source and mode (Page 10).



## Power cycle

- If you are having issues sometimes a box restart is all that's needed. You can restart at [Menu > Manage > Settings > Device Info > Options > Fetch Box restart](#).
- Or restart by pressing  then  on your Fetch remote.
- If your menu isn't working try turning the power to the box off for 10 seconds before turning it back on.

## Internet connection

- Double-check that the broadband connection is active.  
The LED  on the your Fetch Mighty should be lit blue. If using an Ethernet connection, also check that the indicator lights on your modem are on. If using Power Line Adapters, check the status lights on the adapters.
- If there's no broadband connection, check you can browse the internet on a computer or smartphone connected to the same router as your Fetch Mighty. If not, contact your broadband provider. If you can, power cycle your Fetch Mighty.
- If connecting through Wi-Fi and you don't see your home network in the list of available networks, try refreshing the list of networks or restart your modem and wait a few minutes to see if your home network appears. Alternatively try to add your home network manually (you'll need the network name and password).

## Remote Control

- Use the voice remote control (Page 14) within 10 metres of the Fetch Mighty when paired in Bluetooth mode.
- For non-Bluetooth remote controls (Page 13), use the remote within 6 metres of the Fetch Mighty.
- If the LED at the top of the remote control does not light up when a button is pressed, change the batteries.
- For issues with voice search through the voice remote, check the remote is paired. Press any button and make sure the LED is green. If the LED is red, press and hold  while pointing at your Fetch Mighty to pair or go to [Menu > Manage > Settings > Remote Control](#). If that doesn't help, press and hold  and  at the same time while pointing at your Fetch Mighty, to re-pair the remote.

# Specifications

## 3rd Generation Mighty (M616T)

Input	Connector	Specification	Signal
Power	DC Male jack (5.5mm diameter)	Input 220V AC Output 12V DC 2A	
Antenna	RF Connector	50 Ohms	Channel Bandwidth 7 or 8 MHz
Broadband	RJ-45	Ethernet	IPv4
Data	2 x USB	USB 2.0, USB 3.0	Host
Output	Connector	Specification	Signal
Digital Video + Digital Audio	HDMI 2.0	HDCP 2.2 content protected	720p50, 1080i60, 1080p50, 1080p60, 4Kp60
Surround Audio	TOSLINK	S-P/DIF	Optical

Other		
Dimensions		260(W) x 260(L) x 60mm(H)
Max Weight		3.43kg (inc. packaging)
Max Power Consumption		Up to 20W
Operating Temperature Range		+5 to +45 deg C
Storage Temperature Range		-20 to +70 deg C
Humidity		10 to 90% NC
Hard Drive Capacity		1TB
RAM		3GB SDRAM
Flash		4GB eMMC
Tuners		4 x DVB-T
Video Decode		MPEG4 HD, H.264 AVC, H.265 HEVC
Audio Decode		MPEG4 AAC, MPEG 4 HE-AAC v2
Surround Sound Support		Dolby Digital Surround 5.1 (AC3) and Dolby Digital Plus (Enhanced AC3), Dolby Atmos
Wi-Fi		802.11/b/g/n/ac, 2.4Ghz/5Ghz
Bluetooth		4.1 LE
4K Capability		Yes
HDR		HDR10

4th Generation Mighty (M681T)

Input	Connector	Specification	Signal
Power	DC Male jack (5.5mm diameter)	Input 220V AC Output 12V DC 2.0A	
Antenna	RF Connector	50 Ohms	Channel Bandwidth 7 or 8 MHz
Broadband	RJ-45	Ethernet	IPv4
Data	1 x USB	USB 2.0	Host
Output	Connector	Specification	Signal
Digital Video + Digital Audio	HDMI 2.0	HDCP 2.2 content protected	720p50, 1080i60, 1080p50, 1080p60, 2160p60
Surround Audio	TOSLINK	S-P/DIF	Optical

Other		
Dimensions		260(W) x 260(L) x 60mm(H)
Max Weight		3.43kg (inc. packaging)
Max Power Consumption		Up to 20W
Operating Temperature Range		+5 to +45 deg C
Storage Temperature Range		-20 to +70 deg C
Humidity		10 to 90% NC
Hard Drive Capacity		1TB
RAM		4GB LPDDR4
Flash		8GB eMMC
Tuners		4 x DVB-T2
Video Decode		MPEG4 HD, H.264 AVC, H.265 HEVC, AV1
Audio Decode		MPEG4 AAC, MPEG 4 HE-AAC v2
Surround Sound Support		Dolby Digital Surround 5.1 (AC3) and Dolby Digital Plus (Enhanced AC3), Dolby Atmos
Wi-Fi		IEEE 802.11ax, 2.4Ghz/5Ghz
Bluetooth		5.0
4K Capability		Yes
HDR		HDR10, Dolby Vision

# Compliance

**Product Code M616T**

This product complies with the following Standards:

Electrical Safety	AS/NZS 60065.1-2008
RF Emissions	AS/NZS CISPR 13 and 22
C-Tick Supplier Code	N25670

**Product Code M681T**

This product complies with the following Standards:

Electrical Safety	AS/NZS 62368.1:2018
RF Emissions	AS/NZS CISPR 32:2015
C-Tick Supplier Code	N25670

# Contact

Fetch  
contactus@fetchtv.com.au  
ABN: 36 130 669 500  
fetch.com.au

# Keep in touch

Like our Facebook page [facebook.com.au/fetchtv](https://facebook.com.au/fetchtv) to get all of our updates.

If you have an account directly with Fetch please log in to [fetch.com.au/account](https://fetch.com.au/account) to access the online troubleshooting, or contact your Fetch Service Provider for assistance.

## User Guides

You can download the following User Guides from [fetch.com.au/guides](https://fetch.com.au/guides)

- 1 Fetch Mighty User Guide.
- 2 Universal Remote Instructions.
- 3 Mobile App Guide.
- 4 My Media Hub User Guides.
- 5 Wi-Fi User Guide.
- 6 Multiroom User Guide.





**[fetch.com.au](https://fetch.com.au)**

© Fetch TV Pty Limited. ABN 36 130 669 500. All rights reserved. Fetch TV Pty Limited is the owner of the trade marks Fetch. The set top box and the Fetch service may only be used lawfully and in accordance with relevant terms of use of which you are notified by your service provider. You must not use the electronic program guide, or any part of it, for any purpose other than private and domestic purposes and you must not sub-licence, sell, lease, lend, upload, download, communicate or distribute it (or any part of it) to any person.

Version: January 2023